



For questions or help with this product contact Tech Support at (570) 546-9663 or techsupport@grizzly.com

MODEL H8088 2-STAGE TRANSMISSION JACK INSTRUCTIONS

Introduction

Anyone removing or replacing a transmission under a lift will appreciate having this 2-Stage Transmission Jack. A foot activated pump raises this jack from 34" to 71³/₈", freeing hands to guide the jack and safely secure the transmission. Its wide base with 4 steel casters provide plenty of stability and a swivel tow handle make it highly maneuverable in the lowered position.



Specifications

Maximum Lifting Capacity 1,100 lbs.
Lifting Range 34"-71³/₈"
Weight 138 lbs.

⚠WARNING

This jack is designed to assist in transmission removal only. Failure to follow these instructions when using the transmission jack could result in serious personal injury or death:

1. Only use this jack on hard level surfaces such as concrete or asphalt.
2. **DO NOT** overload this jack beyond the maximum lifting capacity. Overloading can cause the jack to collapse.
3. **DO NOT** use this jack to lift or support a vehicle.
4. Keep fingers and hands away from pinch points when lowering.
5. Only transport load with jack platform in the lowered position and properly secured with chain.
6. Center load on jack for stability.
7. Always use safety chain to secure load immediately after placing it on jack.

Inventory

Primary Components		Qty
A.	Half-Circle Handle	1
B.	Leg	2
C.	Angle Iron Bracket.....	2
D.	Platform Assembly	1
E.	Pump Assembly	1

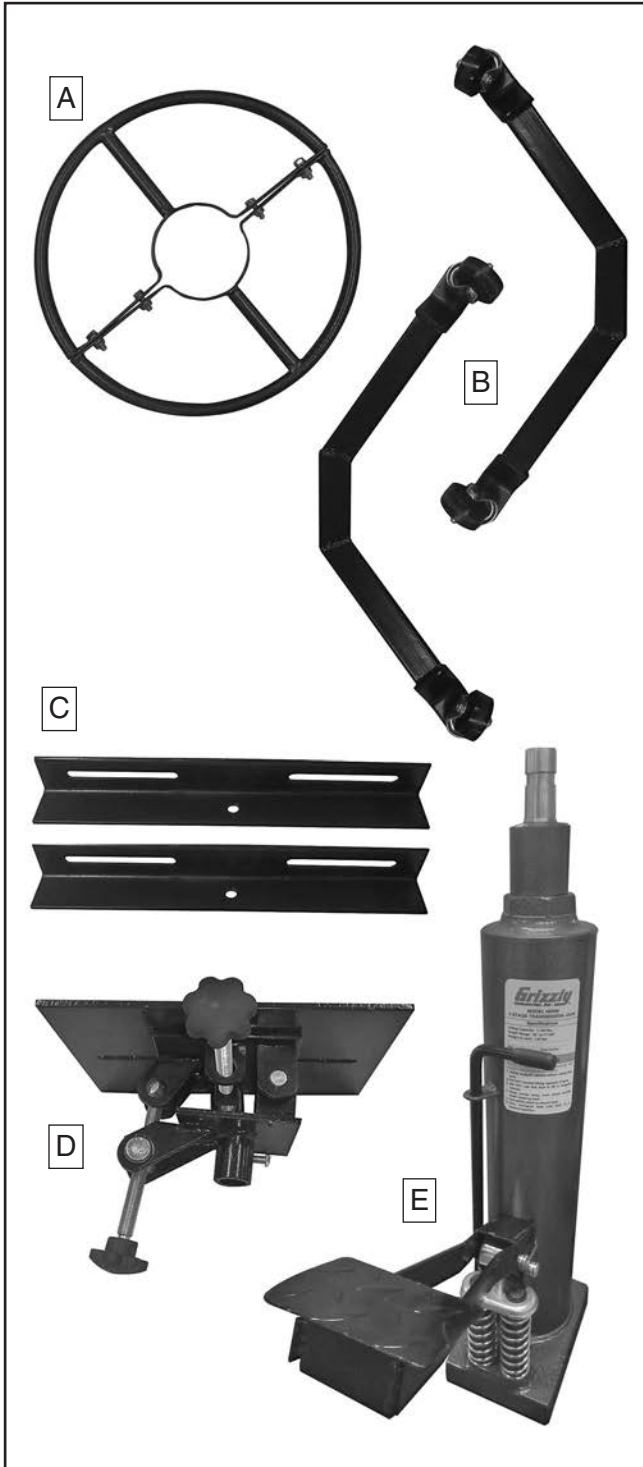

Figure 1. H8088 primary components.

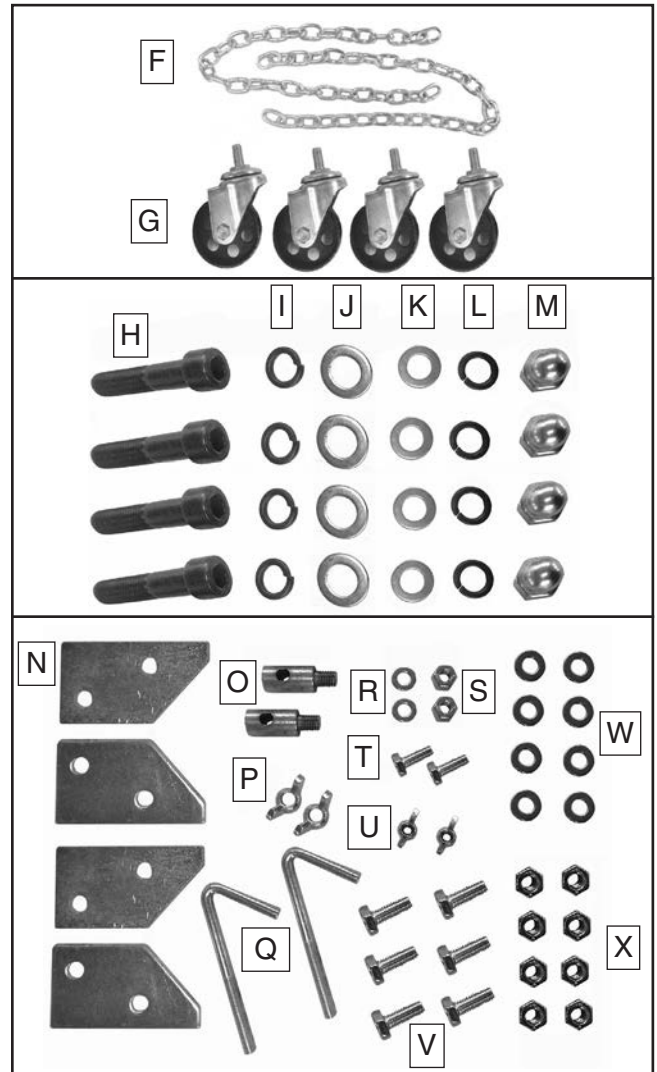

Figure 2. H8088 boxed components.

Boxed Components		Qty
F.	Chain 9mm ID, 28 Link.....	2
G.	Caster Wheels M12-1.75 x 25 Stud	4
H.	Cap Screws M16-2 x 75	4
I.	Lock Washers 16mm.....	4
J.	Flat Washers 16mm	4
K.	Flat Washers 12mm	4
L.	Lock Washers 12mm.....	4
M.	Acorn Nuts M12-1.5	4
N.	Chain Mount Plates	4
O.	Threaded Rod Ends M10-1.5 x 14, 16 x 31	2
P.	Wing Nuts M10-1.5	2
Q.	Anchor Bolts M8-1.25 x 108	2
R.	Flat Washers 8mm	2
S.	Hex Nuts M8-1.25.....	2
T.	Wing Nuts M8-1.25.....	2
U.	Hex Bolts M8-1.25 x 25	2
V.	Hex Bolts M10-1.5 x 25	6
W.	Flat Washers 10mm	8
X.	Hex Nuts M10-1.5	8



Assembly

Tools Needed for Assembly	Qty
Hex Wrench 12mm.....	1
Wrench 14mm.....	1
Wrench 17mm.....	1
Wrench 19mm.....	1

Assembling the Jack

1. Attach casters to legs using (1) 12mm flat washer, 12mm lock washer, and M12-1.75 acorn nut on each (see **Figure 3**).

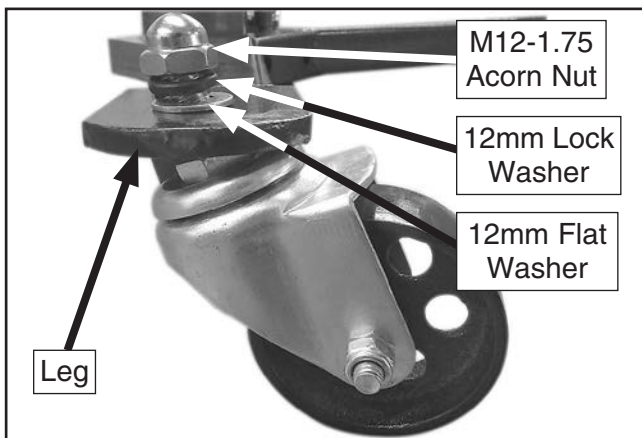

Figure 3. Caster attached to leg before tightening acorn nut.

2. Attach each leg to pump assembly with (2) M16-1.75 x 70 cap screws, 16mm flat washers, and 16mm lock washers (see **Figure 4**).

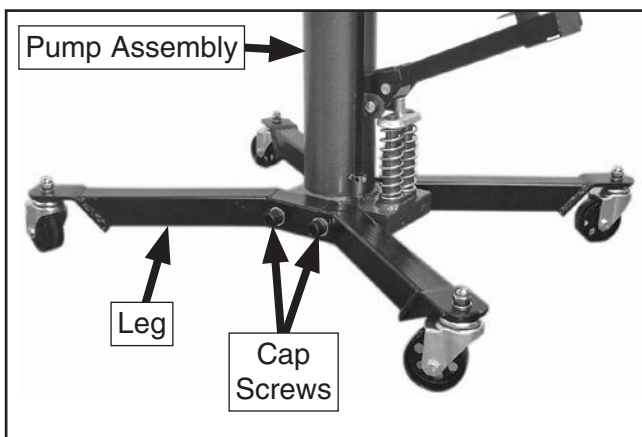

Figure 4. Legs attached to pump assembly.

3. Secure half-circle handle on top edge of pump assembly (see **Figure 5**) with pre-installed hex nuts and bolts.

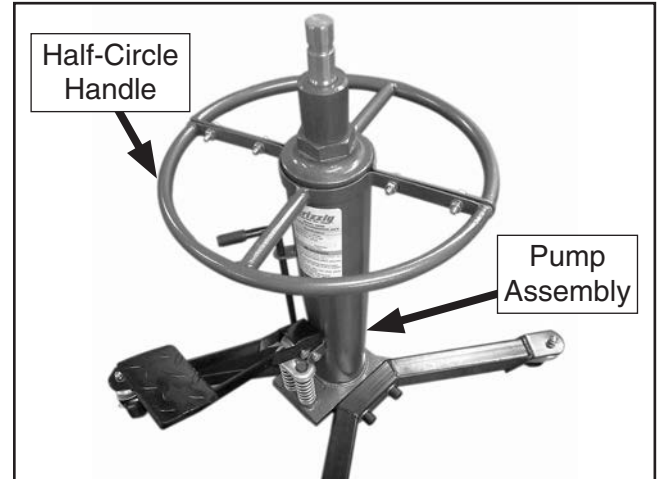

Figure 5. Half-circle handle secured at top of pump assembly.

4. Set platform assembly on top of pump assembly ram and tighten pre-installed hex bolt (see **Figure 6**).

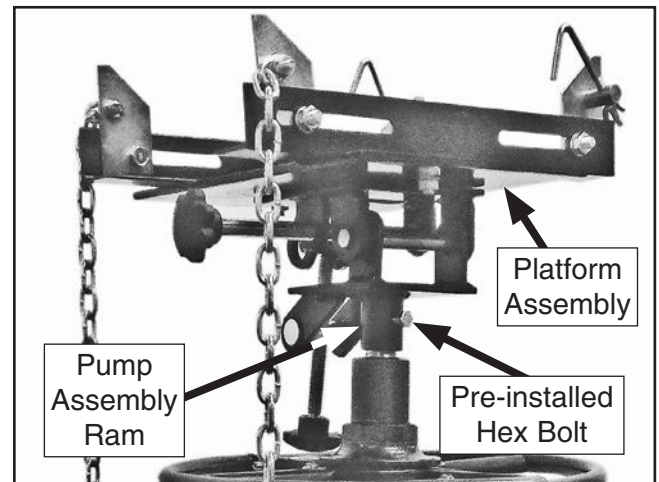

Figure 6. Platform assembly mounted to pump assembly ram (chain mount plates, chains, and anchor bolt shown attached).



- Attach an angle-iron bracket to each side of platform assembly. Place (1) M10-1.5 x 25 hex bolt through hole in angle iron bracket and slot in platform. Secure from below with (1) 10mm flat washer and M10-1.5 hex nut (see **Figure 7**).

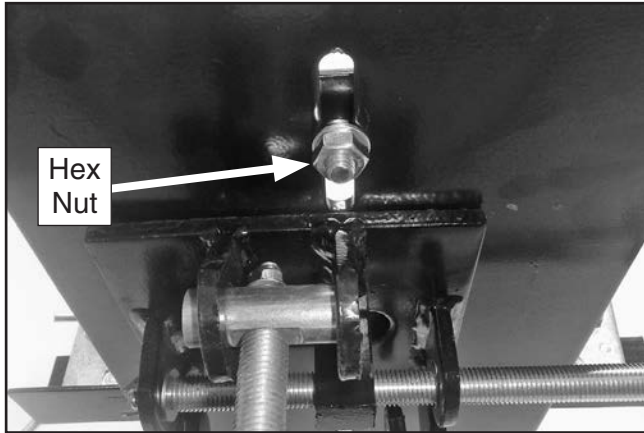

Figure 7. M10-1.5 hex nut secures angle-iron bracket to platform below. Slot allows horizontal adjustment in platform.

- Install (2) chain mount plates on inside edges of each angle-iron bracket with (1) M10-1.5 x 25 hex bolt, 10mm flat washer, and M10-1.5 hex nut, as shown in **Figure 8**.

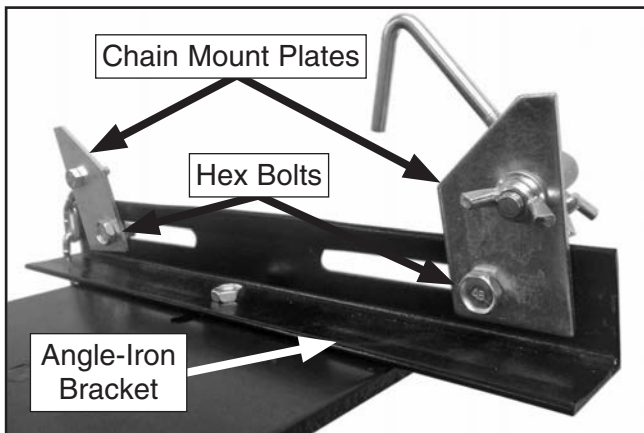

Figure 8. Chain mount plates attached to angle-iron bracket.

- Attach (1) threaded rod end to each chain mount plate with (1) 10mm flat washer and M10-1.5 wing nut, as shown in **Figure 9**.
- Slide threaded end of anchor bolt through rod end and attach with M8-1.25 wing nut (see **Figure 9**).

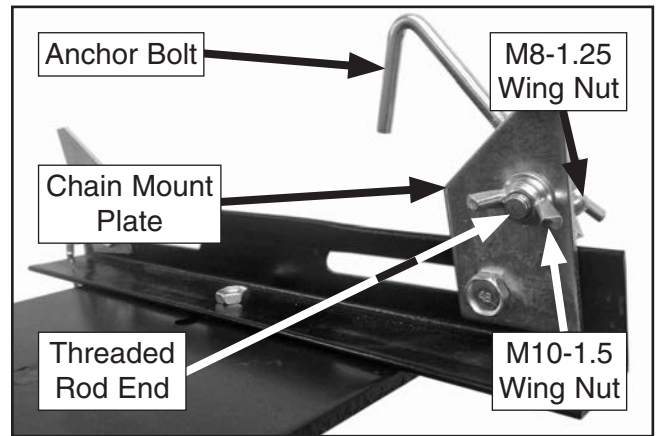

Figure 9. Threaded rod end and anchor bolt attached to chain mount plate.

- Place M8-1.25 x 25 hex bolt through open bolt hole in chain mount plate. Attach last chain link with 8mm flat washer and M8-1.25 hex nut (see **Figure 10**). Repeat for opposite corner. Chain connects to unthreaded end of anchor bolt to secure load to platform.

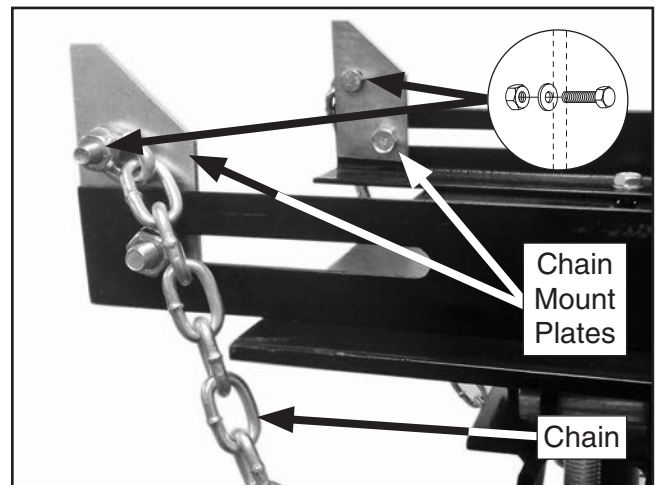

Figure 10. Chain bolted to chain mount plates.



Operation

Pump Control Handle (Figure 11): Point to the left to allow the jack platform to lift when pumped. Point to the right to lower the jack. (If the jack holds a heavy load, turn very slowly to control the lowering rate and avoid dropping the load.)

Foot Pedal Pump (Figure 11): When moved up and down, the foot pedal pump lifts the jack platform.

Platform Adjustment Knobs (Figure 11): Located under the jack platform, these knobs allow for precision placement and leveling of the loaded platform. The upper knob adjusts the platform's lateral movement. The lower knob adjusts the platform's tilt.

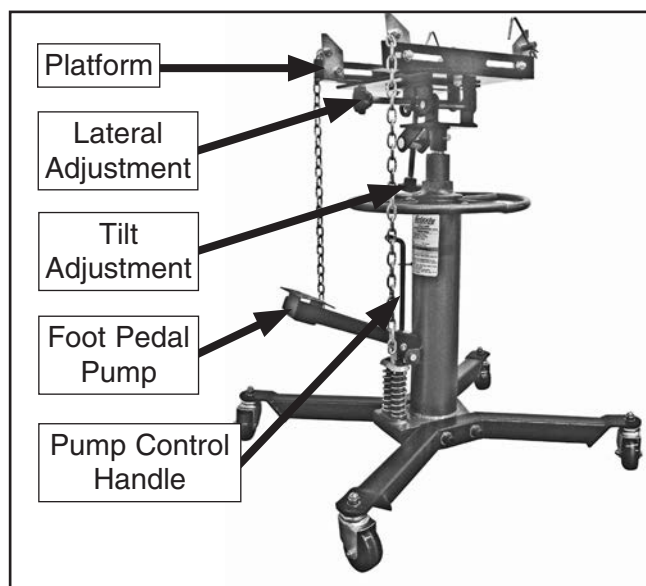

Figure 11. H8088 2-Stage Transmission Jack operational components.

Platform Adjustments (Figure 12): Slide the angle iron brackets to adjust for the width of the transmission. Use the lateral adjustment knob and tilt adjustment knob to help mount the transmission to the engine.

Chain Adjustments (Figure 12): Slide the chain mount plates fore and aft on the angle iron bracket to adjust the chain length for the height of the transmission in a cross pattern as shown. Adjust orientation of threaded rod ends and anchor bolts as needed. Tighten all hex nuts on chain mount plates and wing nuts on threaded rod ends before loading the platform. Place each open end of chain onto anchor bolt and tighten its wing nut to secure the load before lowering.



Figure 12. Chain attachment and platform adjustments.



Maintenance

The Model H8088 will require additional hydraulic fluid after long-term use. This will be noticeable if the jack will not reach its maximum height.

To add hydraulic fluid, remove the air-vent fill bolt, shown in **Figure 13**, and add fluid until it reaches the top of the fill hole.

Keep the hydraulic ram clean and free of any dust, dirt, or foreign debris. Abrasive material stuck to the ram can damage the hydraulic seal when the ram is retracted back into the jack. Regularly wipe the hydraulic ram clean with a lightly oiled rag.

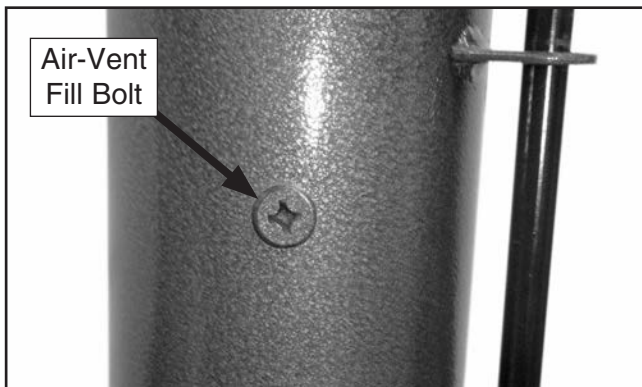

Figure 13. Air-vent fill hole allows for addition of hydraulic fluid.

Bleeding the Pump

If the jack becomes "spongy" or will not rise when pumped, air bubbles may be trapped in the pump assembly's hydraulic system. These can be removed by following the instructions below.

To remove air bubbles:

1. Remove the platform assembly.
2. Pump the foot pedal to expose about 4 inches of the lower ram shaft.
3. With a rag, hold the ram shaft and turn the collar counterclockwise until shaft threads are visible.
4. Hold a rag below the collar and gently press down on the foot pedal until fluid comes out. Repeat as needed until the air bubbles stop coming out in the hydraulic fluid.
5. When the fluid runs freely without air bubbles, tighten the collar, wipe up spilled fluid, and replace the platform assembly.
6. Remove the air-vent fill bolt and check the fluid level. Add fluid if necessary.



H8088 Parts Breakdown and Parts List

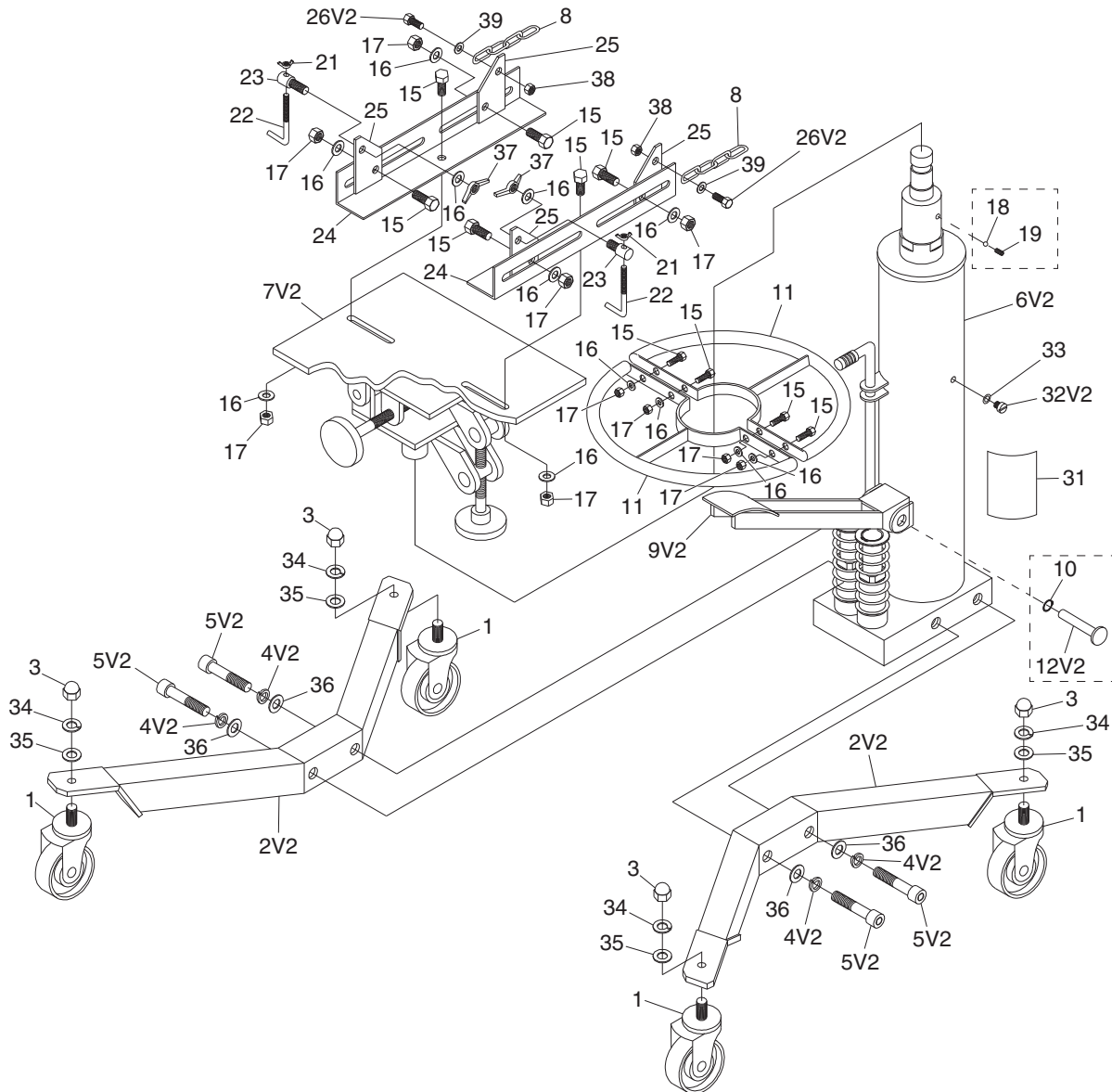

REF	PART #	DESCRIPTION
1	PH8088001	CASTER WHEEL M12-1.75 X 25 STUD
2V2	PH8088002V2	LEG V2.01.11
3	PH8088003	ACORN NUT M12-1.75
4V2	PH8088004V2	LOCK WASHER 16MM
5V2	PH8088005V2	CAP SCREW M16-2 X 75
6V2	PH8088006V2	PUMP ASSEMBLY V2.01.11
7V2	PH8088007V2	PLATFORM ASSEMBLY V2.01.11
8	PH8088008	CHAIN 9MM ID, 28 LINK
9V2	PH8088009V2	FOOT PEDAL V2.01.11
10	PH8088010	EXT RETAINING RING 16MM
11	PH8088011	HALF-CIRCLE HANDLE
12V2	PH8088012V2	FOOT PEDAL PIN 16 X 60MM V2.01.11
15	PH8088015	HEX BOLT M10-1.5 X 25
16	PH8088016	FLAT WASHER 10MM
17	PH8088017	HEX NUT M10-1.5
18	PH8088018	STEEL BALL 5MM

REF	PART #	DESCRIPTION
19	PH8088019	SET SCREW M6-1 X 10
21	PH8088021	WING NUT M8-1.25
22	PH8088022	ANCHOR BOLT M8-1.25 X 108
23	PH8088023	THREADED ROD END M10-1.5 X 14, 16 X 31
24	PH8088024	ANGLE IRON BRACKET
25	PH8088025	CHAIN MOUNT PLATE
26V2	PH8088026V2	HEX BOLT M8-1.25 X 25
31	PH8088031	MACHINE ID LABEL
32V2	PH8088032V2	AIR VENT FILL BOLT M10-1 X 8 V2.01.11
33	PH8088033	O-RING 7.7 X 1.9
34	PH8088034	LOCK WASHER 12MM
35	PH8088035	FLAT WASHER 12MM
36	PH8088036	FLAT WASHER 16MM
37	PH8088037	WING NUT M10-1.5
38	PH8088038	HEX NUT M8-1.25
39	PH8088039	FLAT WASHER 8MM

Please Note: We do our best to stock replacement parts whenever possible, but we cannot guarantee that all parts shown here are available for purchase. Call (800) 523-4777 or visit our online parts store at www.grizzly.com to check for availability.



grizzly.com[®]

TOOL WEBSITE

Buy Direct and Save with Grizzly[®] – Trusted, Proven and a Great Value!
~Since 1983~

*Visit Our Website Today For
Current Specials!*

**ORDER
24 HOURS A DAY!
1-800-523-4777**

